

AN ORDINANCE AMENDING KING COUNTY ZONING RESOLUTION NO. 25789, AS AMENDED BY AMENDING THE ZONING MAP THEREOF RECLASSIFYING CERTAIN PROPERTY THEREON.

WHEREAS CAMELOT has petitioned King County, requesting reclassification of property described in said petition and all legal requirements have been performed; and

WHEREAS, the Department of Planning has transmitted to the King County Council, King County, Washington, a copy of the Department's findings and action recommending that the Zoning Map be amended and for the reasons stated therein; and

NOW THEREFORE BE IT ORDAINED that the King County Council does hereby adopt the findings and recommendations of the Department of Planning as its own and does hereby reclassify certain property to RD 3600 as shown hereon and legally described herein which lies within the part(s) of the Zoning Map described as Area Map(s) E 4-21-4

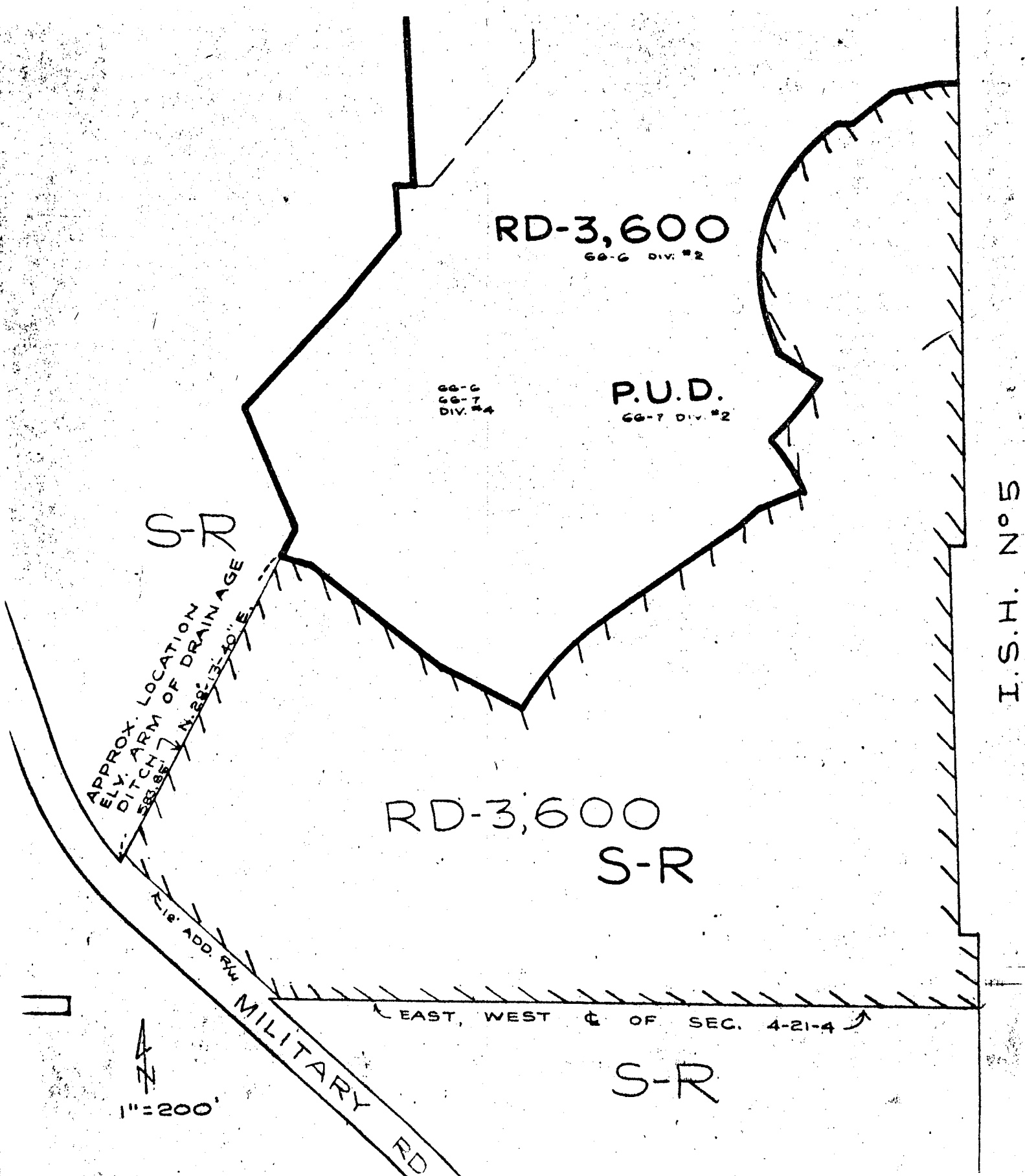

00111

LEGAL DESCRIPTION:

That portion of the N.E. 1/4 of Section 4, Township 21 North, Range 4 East, W. M. in King County, Washington, described as follows:

Commencing at the east quarter corner of said section; thence N 88°18'00" W along the east and west centerline of said section 493.96 feet to intersect the west margin of the Seattle-Tacoma Freeway, as shown on map titled "Primary State Highway No. 1, Pierce County Line to jct. SSH No. 5-A, King County" and approved by the Washington State Director of Highways on Oct. 28, 1958 for right-of-way, Sheet 13 of 20 sheets and the point-of-Beginning; thence continuing N 88°18'00" W along said centerline of Section 1062.56 feet to intersect the northeasterly margin of Military Road; thence N 43°08'00" W along said road margin 208.28 feet to the beginning of a curve to the right with a radius of 674.20 feet; thence northwesterly along said curve through a central angle of 6°15'00" an arc Distance of 73.54 feet; thence N 28°13'40" E 583.85 feet; thence S 63°21'08" E 45.63 feet thence S 43°08'00" E 236.26 feet; thence S 60°40'14" E 60.08 feet; thence S 57°32'33" E 80.00 feet to intersect the arc of a curve at a point from which the center lies S 57°32'33" E and 390.00 feet distant; thence north-easterly along said curve to the right through a central angle of 27°32'33" an arc distance of 187.48 feet to a point of tangency; thence N 60°00'00" E 272.37 feet, thence N 50°25'41" E 32.44 feet; thence N 71°27'11" E 80.00 feet to intersect the arc of a curve of a point from which the center lies S 71°27'11" W and 355.00 feet distant; thence northerly along said curve to the left through a central angle of 15°29'32: an arc distance of 95.99 feet to intersect the arc of a curve at a point from which the center lies N 37°13'37" W and 630.00 feet distant; thence northeasterly along said curve to the left through a central angle of 11°26'30" an arc distance of 125.81 feet; thence N 48°40'07" W 84.52 feet to intersect the arc of a curve at a point from which the center lies N 70°45'41" E and 285.00 feet distant; thence northerly and easterly along said curve to the right through a central angle of 78°30'23" an arc distance of 390.50 feet; thence N 83°32'23" E 28.59 feet; thence N 52°12'17" E 68.35 feet; thence N 78°18'39"E 80.00 feet; thence S 85°37'43" E 21.35 feet to said west margin of the Seattle-Tacoma Freeway; thence S 4°22'17" W along said Freeway margin 713.93 feet; thence N 85°37'43" W 25.00 feet; thence S 4°22'17" W 600.00 feet; thence S 85°37'43" E 25.00 feet; thence S 4°22'17" W 115.70 feet to the Point of Beginning; SUBJECT to modification of a portion of the southerly boundary, as described hereinabove by order of judgement entered in King County Superior Court Cause No. 687237 and filed on May 28, 1968 in Reel 167, Photos 876 through 883. Less County roads.

INTRODUCED and read for the first time this 11th day of August, 1969.

PASSED by the Council at a regular meeting thereof on the 18th day of August, 1969.

W. T. O'Brien
Chairman of the County Council

ATTEST:
Ray Allen
Clerk of the Council

ACTING

APPROVED this 22nd day of August, 1969.

Ed Speltz
King County Executive

ORDINANCE READINGS
1st Aug 11th 1969
2nd Aug 18 1969
3rd Aug 18, 1969
Effective Date _____